

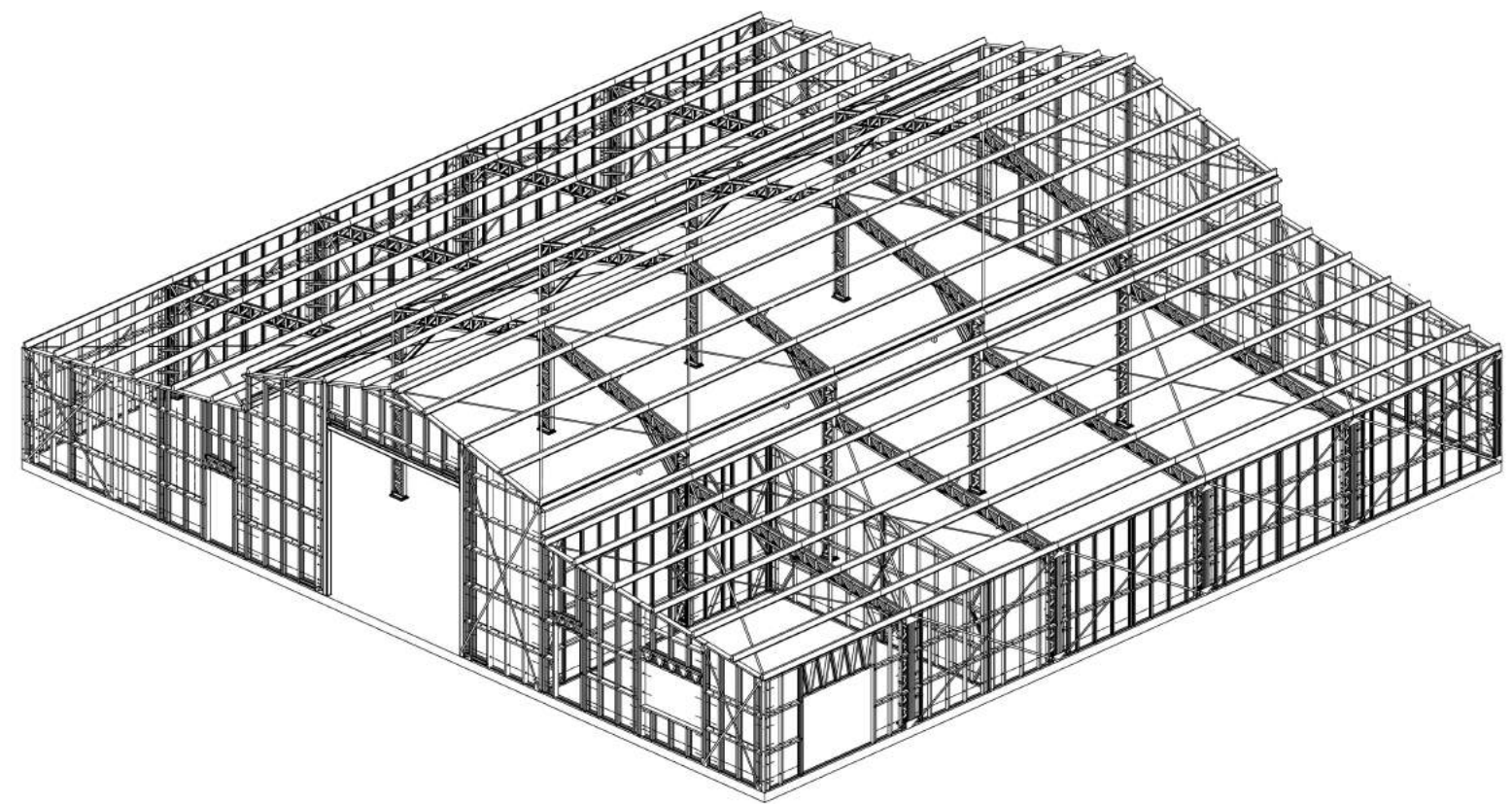

## The Process

In March 2020 Central Steel Framing constructed a 625m<sup>2</sup> Heritage Barn in Taupo. The client came to us with their barn concept and together we developed and engineered a custom designed barn. The light gauge steel barn was built using portal frame construction. The manufacturing and installation of the barn was quick. The steel was assembled in the workshop and erected on site. Only two truckloads were needed to transport the profiles/pre-assembled panels to the site. It only took 24 hours to install the portals and external walls on site.



## Client Feedback

- *"Throughout this process CSF and Warren Farr were instrumental in coming up with solutions that were workable and economical."*
- The client chose to build with Central Steel Framing as *"we are a local company with a focus on customer service who deliver."*







## Light Gauge Steel Benefits

There are many benefits of building with light gauge steel. The client decided to build with light gauge steel because it is accurate, fast and economical.

- "The lightweight steel framing was manufactured quickly and is dimensionally very accurate allowing for quick and precise assembly."
- In terms of time and labour "considerable savings have been achieved over traditional structural steel design with timber framing."

